

# JohnHilton

# JohnHilton

Est 1972

## Ground Floor

Approx. 48.2 sq. metres (519.0 sq. feet)

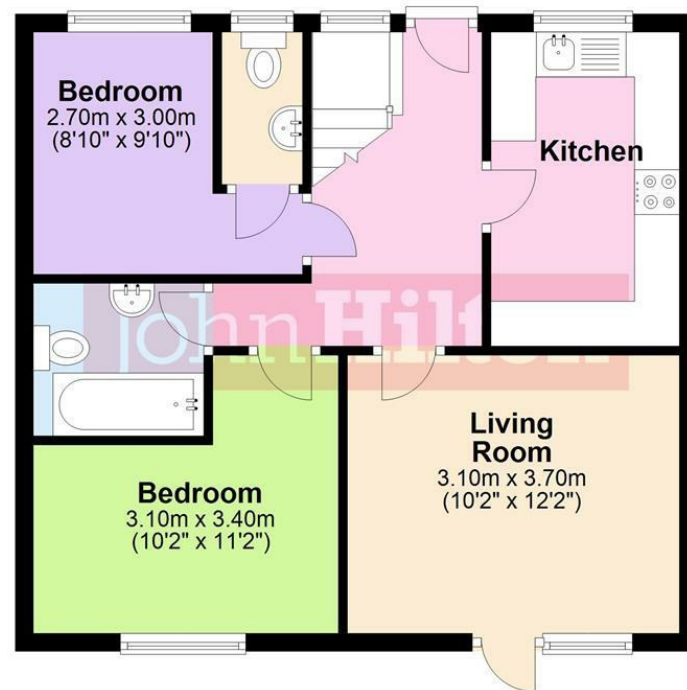

## First Floor

Approx. 48.2 sq. metres (518.9 sq. feet)

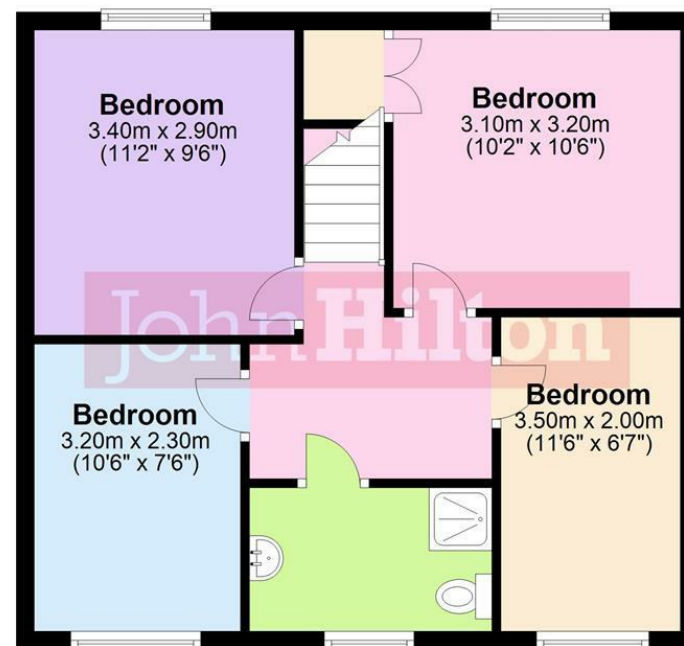

Total area: approx. 96.4 sq. metres (1037.9 sq. feet)



Total Area Approx sq ft

15 Mafeking Road, Brighton, BN2 4EL

To view, contact John Hilton:  
52 High Street, Rottingdean, BN2 7HF  
132-135 Lewes Road, Brighton, BN2 3LG  
01273 608151 or [sales@johnhiltons.co.uk](mailto:sales@johnhiltons.co.uk)

**PCM £3,900 PCM**

view all our properties at:  
[www.johnhiltons.co.uk](http://www.johnhiltons.co.uk)



**Zoopla**

**onTheMarket.com**

**rightmove.co.uk**  
The UK's number one property website

**PrimeLocation.com**





- \* A modern must see 6 bed student house
- \* ONLY £150.00 per person per week
- \* 12 month contract
- \* Available 21st August 2026
- \* Popular location, close to the Lewes Road
- \* Neutral decor
- \* Separate living room and kitchen
- \* Good size rear Garden
- \* On street parking
- \* Shower room and bathroom

\* A holding deposit of £750 will be required to secure the Property which is equivalent to 1 weeks rent. Once referencing is complete the Holding Deposit will go towards the first month's rent on move in

\* The above details are intended for information purposes only and do not constitute an offer or form part of a contract. A tenancy will be granted subject to referencing and contracts

\* Please note that rent is shown as per person per week based on 52 weeks of the year as the rent is due monthly

